

Soils Map

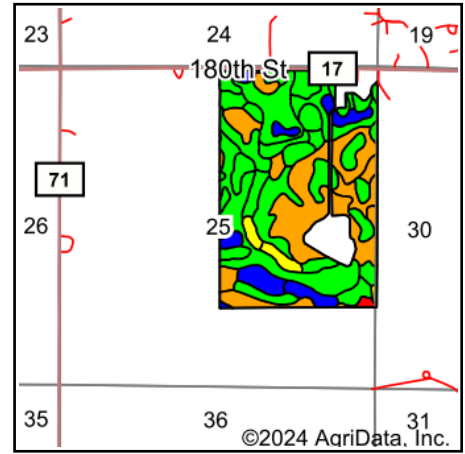

State: **Minnesota**
 County: **Freeborn**
 Location: **25-102N-22W**
 Township: **Pickereel Lake**
 Acres: **213.66**
 Date: **3/26/2024**

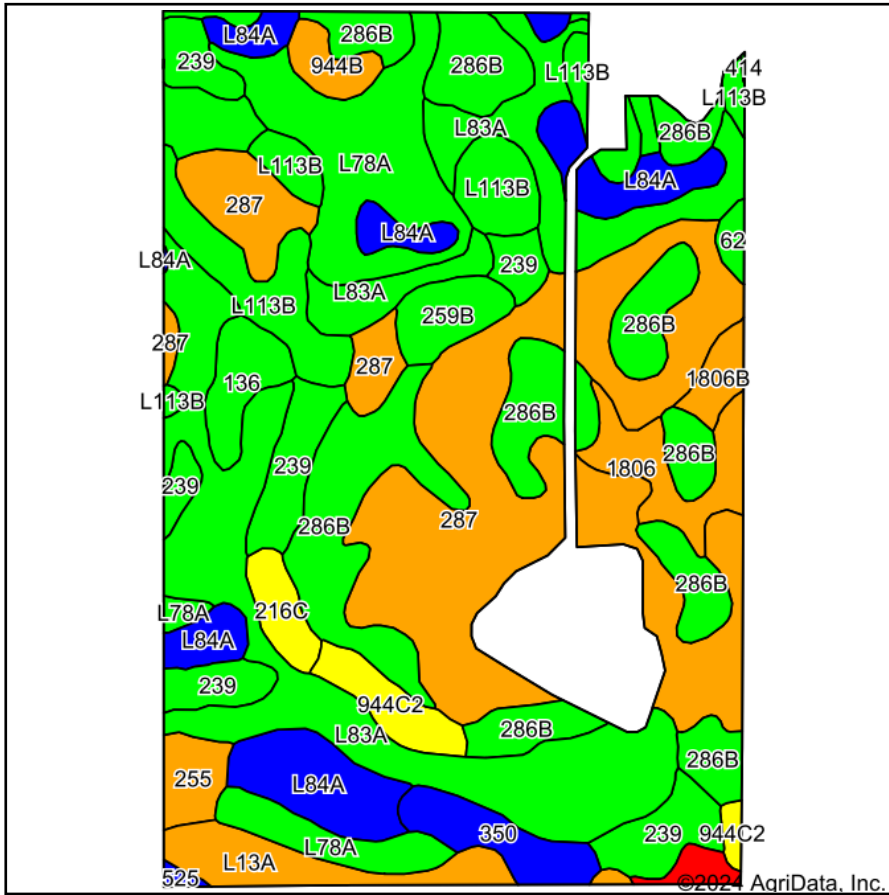

HIGH POINT
 LAND COMPANY

Maps Provided By:



© AgriData, Inc. 2023

www.AgriDataInc.com



Soils data provided by USDA and NRCS.

Area Symbol: MN047, Soil Area Version: 19

Code	Soil Description	Acres	Percent of field	PI Legend	Non-Irr Class *c	Productivity Index	*n NCCPI Overall	*n NCCPI Corn	*n NCCPI Small Grains	*n NCCPI Soybeans
287	Minnetonka silty clay loam	45.36	21.2%		IIw	77	84	84	36	70
L83A	Webster clay loam, 0 to 2 percent slopes	40.75	19.1%		IIw	93	83	78	70	82
286B	Shorewood silty clay loam, 1 to 6 percent slopes	33.04	15.5%		Ile	95	84	84	64	67
L78A	Canisteo clay loam, 0 to 2 percent slopes	17.46	8.2%		IIw	93	81	71	65	81
L84A	Glencoe clay loam, 0 to 1 percent slopes	14.72	6.9%		IIIw	86	77	76	69	76
239	Le Sueur loam, 1 to 3 percent slopes	13.54	6.3%		Iw	97	90	90	76	84
L113B	Reedslake-Le Sueur complex, 1 to 6 percent slopes	13.11	6.1%		Ile	98	81	78	73	81
L13A	Klossner muck, 0 to 1 percent slopes	5.56	2.6%		IIIw	77	84	78	79	84
1806	Lerdal silty clay loam, silty substratum, 0 to 2 percent slopes	4.93	2.3%		IIw	80	84	84	67	68
350	Canisteo clay loam, depressional, 0 to 1 percent slopes	4.12	1.9%		IIIw	86	75	67	61	75
944C2	Lester-Esterville complex, 6 to 12 percent slopes, eroded	3.75	1.8%		IIIe	66	73	73	57	57
136	Madelia silty clay loam, 0 to 2 percent slopes	3.40	1.6%		IIw	94	91	76	75	91

Soils data provided by USDA and NRCS.



Code	Soil Description	Acres	Percent of field	PI Legend	Non-Irr Class *c	Productivity Index	*n NCCPI Overall	*n NCCPI Corn	*n NCCPI Small Grains	*n NCCPI Soybeans
259B	Grays silt loam, 1 to 6 percent slopes	3.22	1.5%		Ile	94	87	86	71	76
255	Mayer loam, 0 to 2 percent slopes	2.43	1.1%		IIw	72	69	69	62	67
216C	Lamont fine sandy loam, 6 to 12 percent slopes	2.36	1.1%		IVe	65	71	71	55	52
944B	Lester-Estherville complex, 2 to 6 percent slopes	2.02	0.9%		Ile	77	78	78	61	63
1806B	Lerdal silty clay loam, silty substratum, 2 to 10 percent slopes	1.73	0.8%		IIle	77	83	83	67	66
1033	Udipsamments	1.09	0.5%			0				
62	Barrington silt loam, 1 to 3 percent slopes	0.76	0.4%		Iw	94	87	87	74	84
525	Muskego soils, 0 to 1 percent slopes	0.31	0.1%		IIIw	81	58	50	57	54
Weighted Average							87.4	*n 79.6	*n 61.1	*n 74.6

*n: The aggregation method is "Weighted Average using all components"

*c: Using Capabilities Class Dominant Condition Aggregation Method

*- Non Irr Class weighted average cannot be calculated on the current soils data due to missing data.