

Soils Map

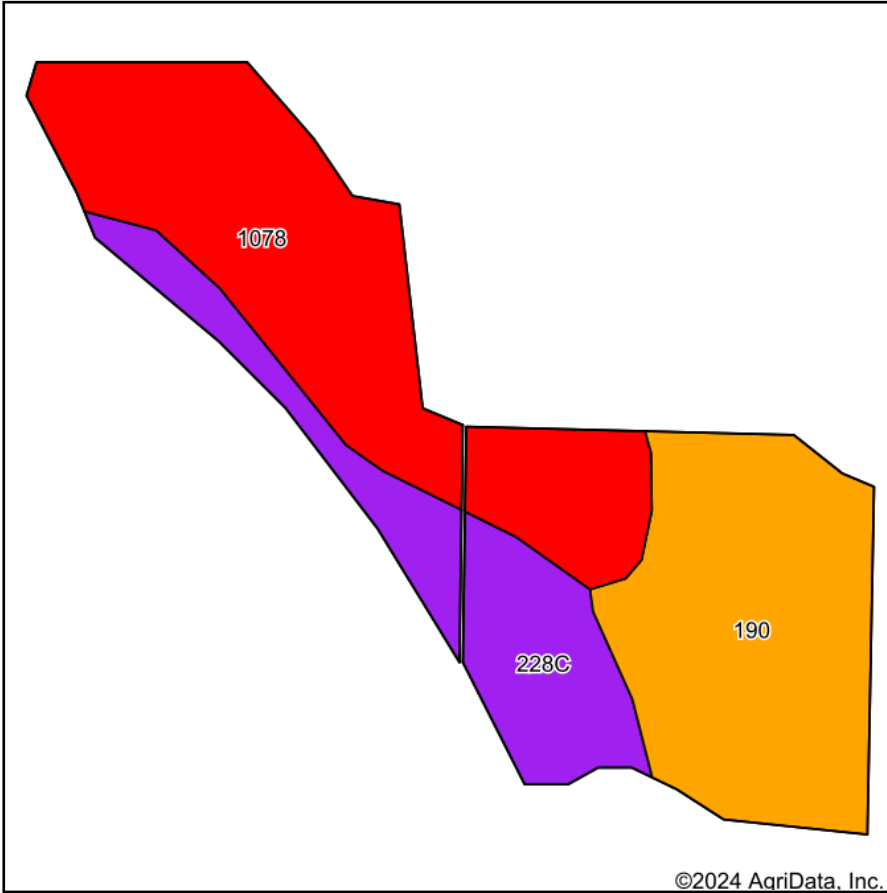

Soils data provided by USDA and NRCS.

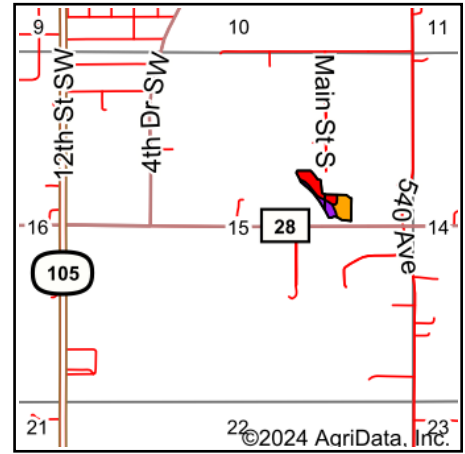

State: **Minnesota**
 County: **Mower**
 Location: **15-102N-18W**
 Township: **Austin**
 Acres: **5.5**
 Date: **7/23/2024**



Maps Provided By:



© AgriData, Inc. 2023

www.AgriDataInc.com



Area Symbol: MN099, Soil Area Version: 19

Code	Soil Description	Acres	Percent of field	PI Legend	Non-Irr Class *c	Productivity Index	*n NCCPI Overall	*n NCCPI Corn	*n NCCPI Small Grains	*n NCCPI Soybeans	
1078	Anthropotic Udorthents, 2 to 9 percent slopes	2.36	42.9%		Vls	0	79	79	69	66	
190	Hayfield loam	1.95	35.5%		Ils	72	80	80	60	50	
228C	Mottland loam, 6 to 12 percent slopes	1.19	21.6%		IIle	56	53	52	47	52	
Weighted Average						3.93	37.6	*n 73.7	*n 73.5	*n 61	*n 57.3

*n: The aggregation method is "Weighted Average using all components"

*c: Using Capabilities Class Dominant Condition Aggregation Method