

Soils Map

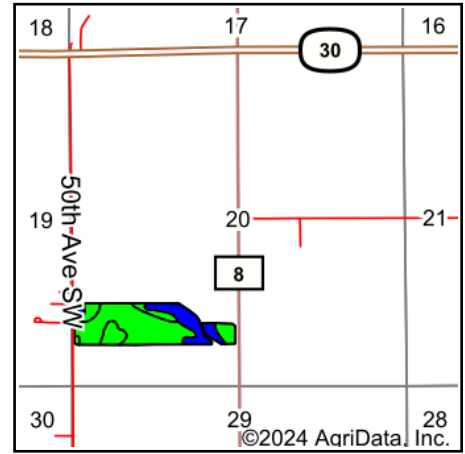

State: **Minnesota**
 County: **Olmsted**
 Location: **20-105N-14W**
 Township: **High Forest**
 Acres: **32.63**
 Date: **7/24/2024**

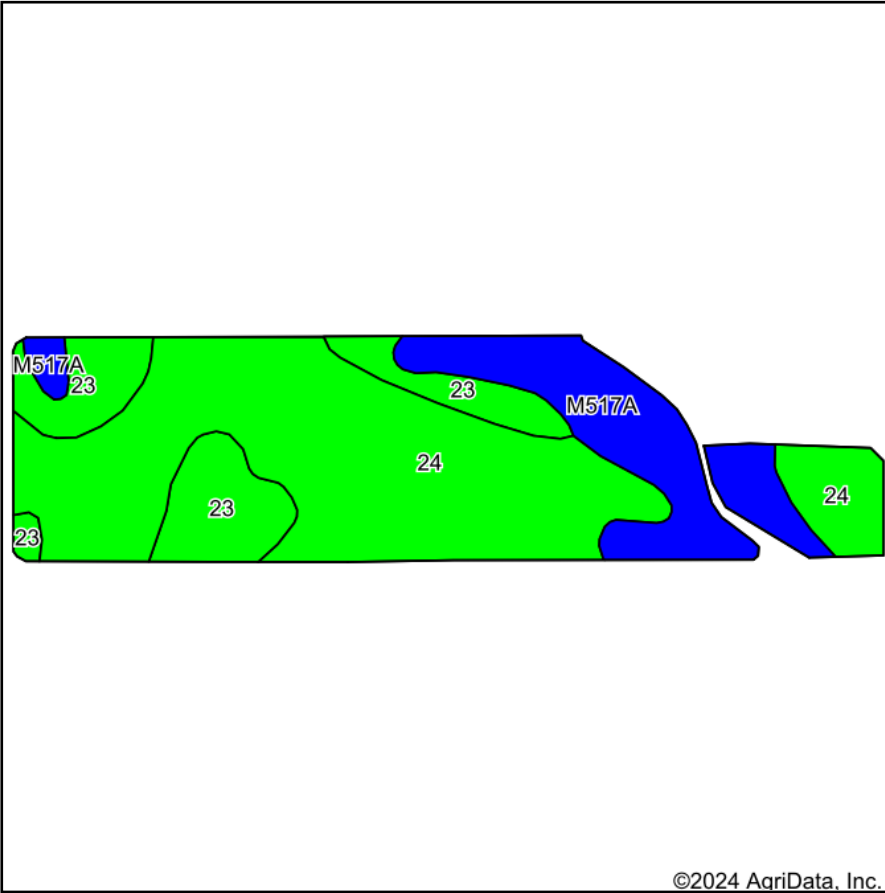

Maps Provided By:



Soils data provided by USDA and NRCS.

Area Symbol: MN109, Soil Area Version: 18

Code	Soil Description	Acres	Percent of field	PI Legend	Non-Irr Class *c	Productivity Index	*n NCCPI Overall	*n NCCPI Corn	*n NCCPI Small Grains	*n NCCPI Soybeans	
24	Kasson silt loam, 1 to 4 percent slopes	19.39	59.4%		Ile	95	79	79	62	63	
M517A	Clyde silty clay loam, 0 to 3 percent slopes	7.08	21.7%		IIw	86	90	90	76	85	
23	Skyberg silt loam, 0 to 3 percent slopes	6.16	18.9%		Iw	95	82	82	64	65	
Weighted Average						1.81	93	*n 82	*n 82	*n 65.4	*n 68.2

*n: The aggregation method is "Weighted Average using all components"

*c: Using Capabilities Class Dominant Condition Aggregation Method