

Soils Map

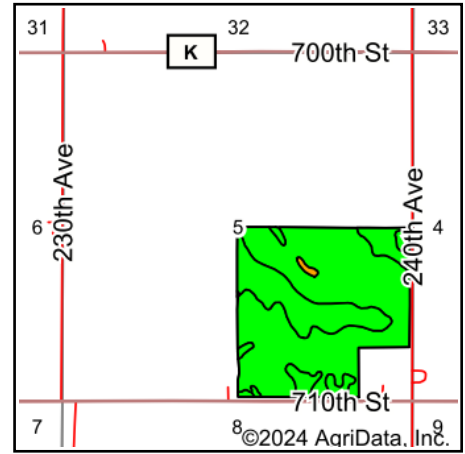

State: **Minnesota**
 County: **Dodge**
 Location: **5-105N-16W**
 Township: **Vernon**
 Acres: **140.9**
 Date: **7/24/2024**

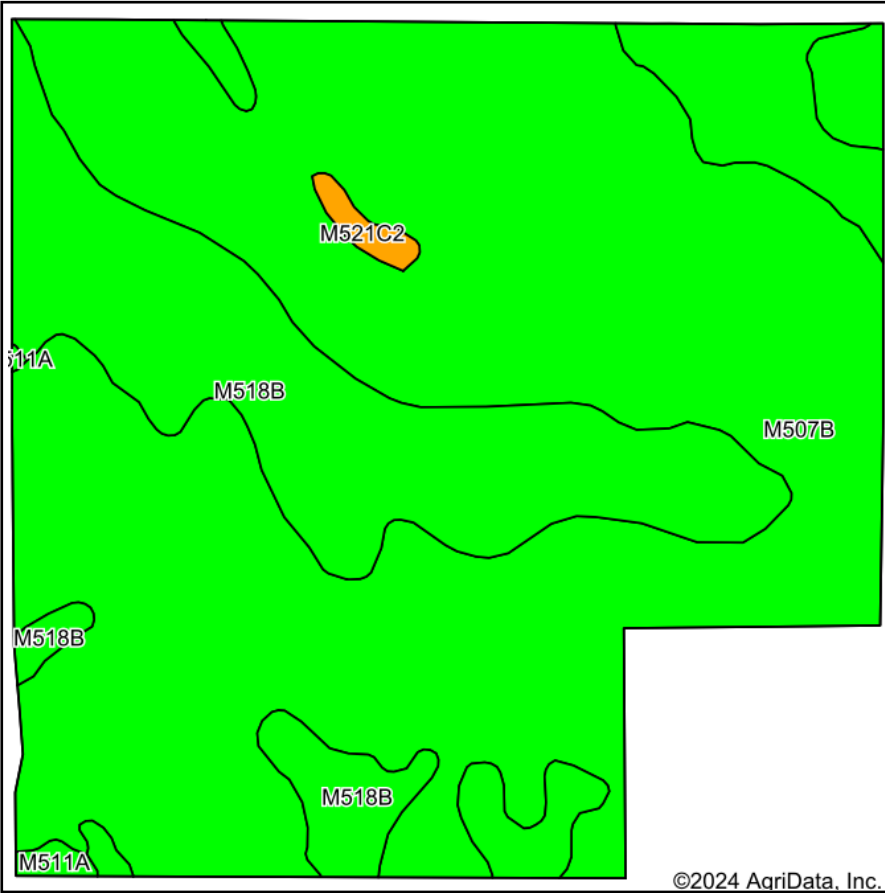

HIGH POINT
 LAND COMPANY

Maps Provided By:



Soils data provided by USDA and NRCS.

Area Symbol: MN039, Soil Area Version: 20

Code	Soil Description	Acres	Percent of field	PI Legend	Non-Irr Class *c	Productivity Index	*n NCCPI Overall	*n NCCPI Corn	*n NCCPI Small Grains	*n NCCPI Soybeans
M507B	Marquis silt loam, 2 to 6 percent slopes	101.89	72.3%		Ile	99	90	90	73	79
M518B	Clyde-Floyd complex, 1 to 4 percent slopes	37.74	26.8%		Ilw	92	87	84	78	87
M521C2	Kenyon silt loam, 6 to 12 percent slopes, moderately eroded	0.76	0.5%		IIIe	79	79	79	66	63
M511A	Readlyn silt loam, 1 to 3 percent slopes	0.51	0.4%		Iw	100	80	80	65	68
Weighted Average					2.00	97	*n 89.1	*n 88.3	*n 74.3	*n 81

*n: The aggregation method is "Weighted Average using all components"

*c: Using Capabilities Class Dominant Condition Aggregation Method