

Soils Map

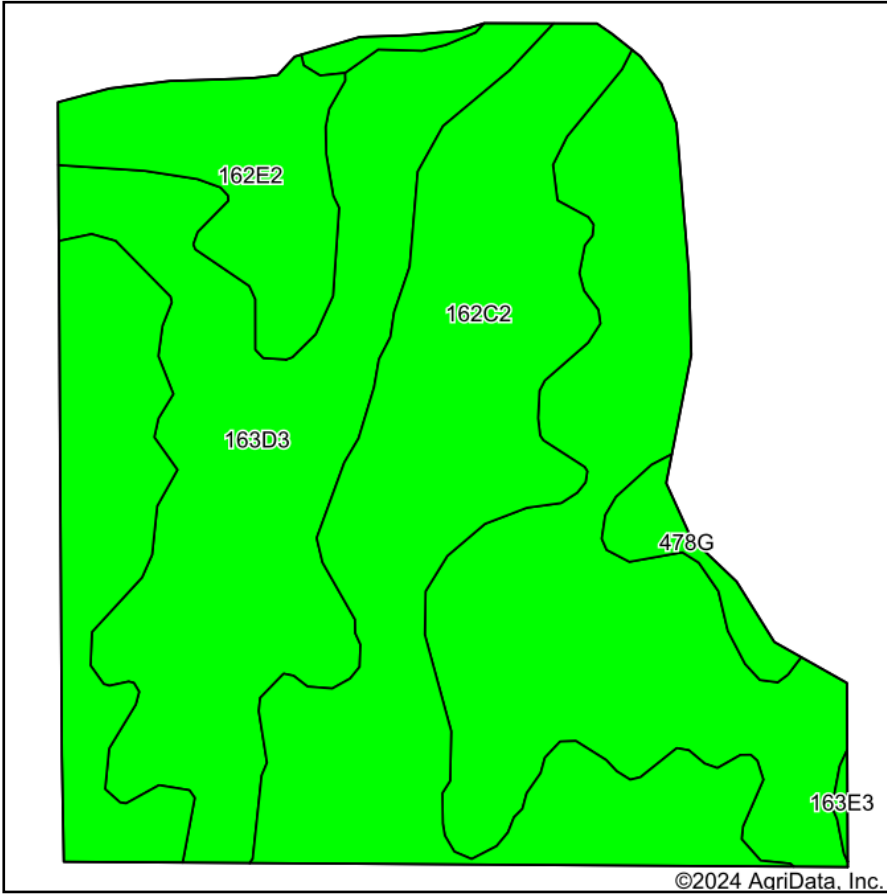

Soils data provided by USDA and NRCS.

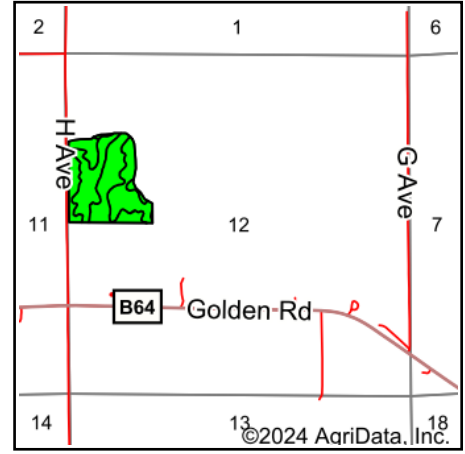

State: **Iowa**
 County: **Fayette**
 Location: **12-94N-8W**
 Township: **Union**
 Acres: **34.2**
 Date: **5/27/2024**



Maps Provided By:



Area Symbol: IA065, Soil Area Version: 28

Code	Soil Description	Acres	Percent of field	CSR2 Legend	Non-Irr Class *c	CSR2**	CSR	*n NCCPI Overall	*n NCCPI Corn	*n NCCPI Small Grains	*n NCCPI Soybeans	
163D3	Fayette silty clay loam, 9 to 14 percent slopes, severely eroded	17.34	50.7%		IVe	40	55	73	73	61	53	
162C2	Downs silt loam, 5 to 9 percent slopes, moderately eroded	13.25	38.7%		IIIe	80		85	85	72	72	
162E2	Downs silt loam, 14 to 18 percent slopes, moderately eroded	2.71	7.9%		IVe	42	53	76	76	64	62	
478G	Rock outcrop-Nordness complex, 25 to 60 percent slopes	0.84	2.5%			5	5	10	10	6	3	
163E3	Fayette silty clay loam, 14 to 18 percent slopes, severely eroded	0.06	0.2%		VIe	29	45	70	70	57	50	
Weighted Average						*-	54.8	*-	*n 76.3	*n 76.3	*n 64.1	*n 59.8

**IA has updated the CSR values for each county to CSR2.

*- CSR weighted average cannot be calculated on the current soils data, use prior data version for csr values.

*n: The aggregation method is "Weighted Average using all components"

*c: Using Capabilities Class Dominant Condition Aggregation Method

*- Non Irr Class weighted average cannot be calculated on the current soils data due to missing data.