

# Soils Map

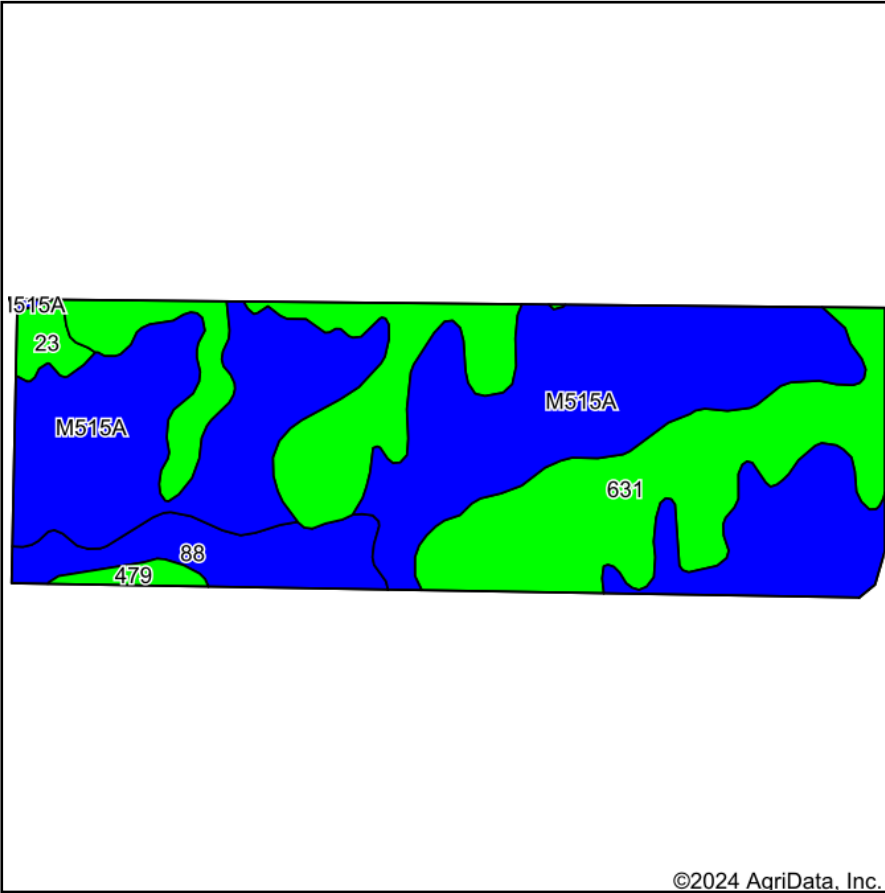

Soils data provided by USDA and NRCS.

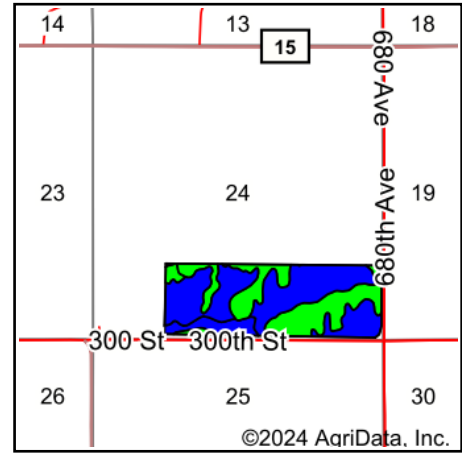

State: **Minnesota**  
 County: **Mower**  
 Location: **24-104N-16W**  
 Township: **Sargeant**  
 Acres: **115.91**  
 Date: **4/30/2024**



Maps Provided By:



© AgriData, Inc. 2023

www.AgriDataInc.com



Area Symbol: MN099, Soil Area Version: 19

Code	Soil Description	Acres	Percent of field	PI Legend	Non-Irr Class *c	Productivity Index	*n NCCPI Overall	*n NCCPI Corn	*n NCCPI Small Grains	*n NCCPI Soybeans	
M515A	Tripoli clay loam, 0 to 2 percent slopes	64.24	55.4%		Ilw	87	68	68	55	63	
631	Oran silt loam, 1 to 4 percent slopes	40.07	34.6%		lw	95	79	79	63	63	
88	Clyde silty clay loam, 0 to 3 percent slopes	8.49	7.3%		Ilw	86	90	90	76	85	
23	Skyberg silt loam, 0 to 3 percent slopes	1.86	1.6%		lw	95	82	82	64	65	
479	Floyd silt loam, 1 to 4 percent slopes	1.25	1.1%		Ilw	100	76	71	58	75	
<b>Weighted Average</b>						<b>1.64</b>	<b>90</b>	<b>*n 73.7</b>	<b>*n 73.7</b>	<b>*n 59.5</b>	<b>*n 64.8</b>

\*n: The aggregation method is "Weighted Average using all components"

\*c: Using Capabilities Class Dominant Condition Aggregation Method

Soils data provided by USDA and NRCS.