

Soils Map

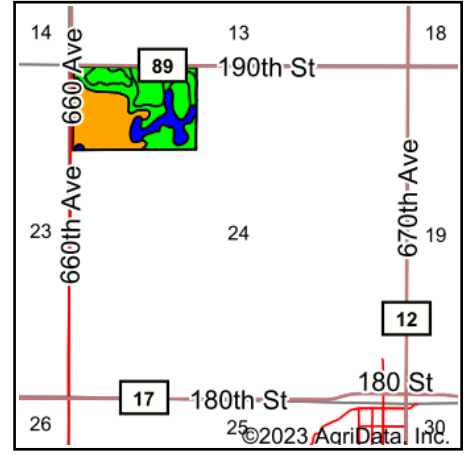

State: **Minnesota**
 County: **Freeborn**
 Location: **24-102N-23W**
 Township: **Alden**
 Acres: **57.03**
 Date: **12/21/2023**

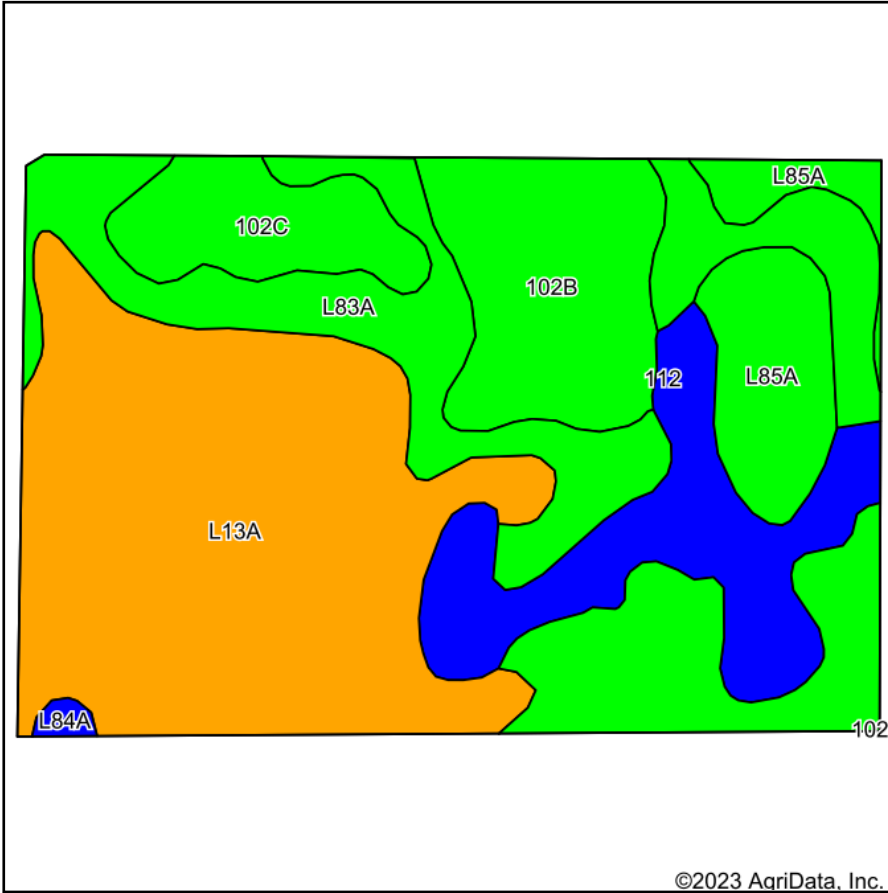

Maps Provided By:



Soils data provided by USDA and NRCS.

©2023 AgriData, Inc.

© AgriData, Inc. 2023

www.AgriDataInc.com

Area Symbol: MN047, Soil Area Version: 19

Code	Soil Description	Acres	Percent of field	PI Legend	Non-Irr Class *c	Productivity Index	*n NCCPI Overall	*n NCCPI Corn	*n NCCPI Small Grains	*n NCCPI Soybeans	
L13A	Klossner muck, 0 to 1 percent slopes	20.32	35.6%		IIIw	77	84	78	79	84	
L83A	Webster clay loam, 0 to 2 percent slopes	15.29	26.8%		IIw	93	83	78	70	82	
112	Harp clay loam, 0 to 2 percent slopes	6.97	12.2%		IIw	90	82	70	63	82	
102B	Clarion loam, 2 to 6 percent slopes	6.37	11.2%		IIe	95	83	78	72	83	
L85A	Nicollet clay loam, 1 to 3 percent slopes	4.41	7.7%		Iw	99	81	81	74	81	
102C	Clarion loam, 6 to 10 percent slopes	3.45	6.0%		IIIe	92	79	75	68	79	
L84A	Glencoe clay loam, 0 to 1 percent slopes	0.22	0.4%		IIIw	86	77	76	69	76	
Weighted Average						2.34	87.5	*n 82.8	*n 77.1	*n 72.8	*n 82.5

*n: The aggregation method is "Weighted Average using all components"

*c: Using Capabilities Class Dominant Condition Aggregation Method

Soils data provided by USDA and NRCS.