

# Soils Map

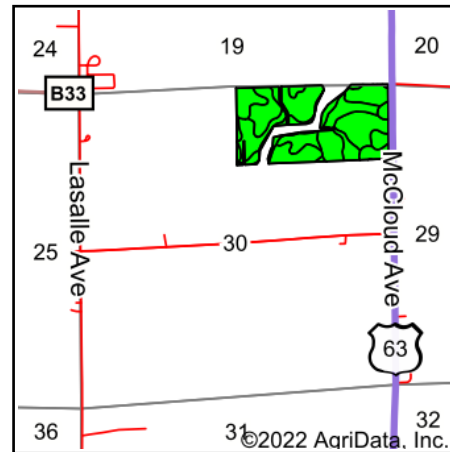

State: **Iowa**  
 County: **Chickasaw**  
 Location: **30-96N-12W**  
 Township: **Jacksonville**  
 Acres: **66.16**  
 Date: **11/2/2022**

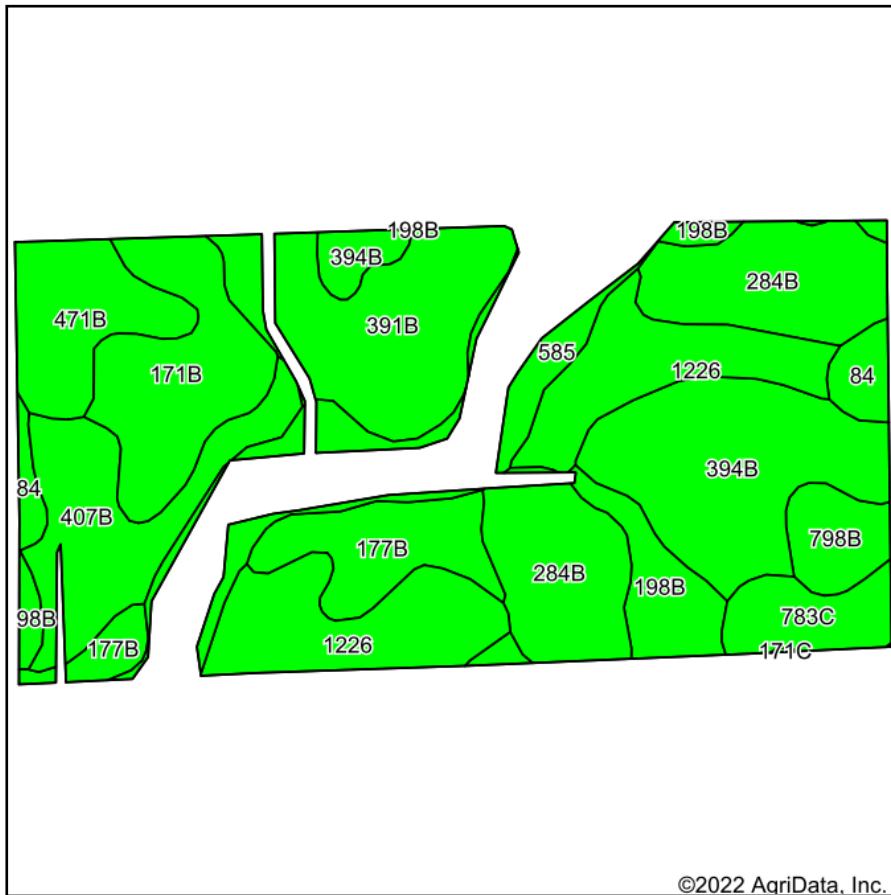

Maps Provided By:



Soils data provided by USDA and NRCS.

©2022 AgriData, Inc.

© AgriData, Inc. 2021

www.AgriDataInc.com

Area Symbol: IA037, Soil Area Version: 27

Code	Soil Description	Acres	Percent of field	CSR2 Legend	Non-Irr Class *c	CSR2**	CSR	Corn Bu	Soybeans Bu	*n NCCPI Overall	*n NCCPI Corn	*n NCCPI Small Grains	*n NCCPI Soybeans	*n NCCPI Cotton	
1226	Lawler loam, 0 to 2 percent slopes, rarely flooded	9.25	14.0%		lls	59	71			83	83	70	61	1	
284B	Flagler sandy loam, 2 to 5 percent slopes	9.08	13.7%		llle	49	45			63	63	56	37		
394B	Ostrander loam, 2 to 5 percent slopes	8.94	13.5%		lle	88	84			77	77	70	67		
391B	Clyde-Floyd complex, 1 to 4 percent slopes	7.30	11.0%		llw	87	72			88	86	70	85		
171B	Bassett loam, 2 to 5 percent slopes	5.76	8.7%		lle	85	79	215	62	88	88	69	76		
407B	Schley loam, 1 to 4 percent slopes	5.54	8.4%		llw	81	69			95	95	79	86		
177B	Saude loam, 2 to 5 percent slopes	4.35	6.6%		lls	55	57			76	76	63	59		
471B	Oran loam, 2 to 5 percent slopes	3.88	5.9%		lw	74	79			80	80	53	59		
585	Coland-Spillville complex, 0 to 2 percent slopes, occasionally flooded	3.37	5.1%		llw	70	85			77	77	33	68		
198B	Floyd loam, 1 to 4 percent slopes	3.19	4.8%		llw	89	74			85	81	63	85		
783C	Cresco loam, 5 to 9 percent slopes	2.22	3.4%		llle	81	46			87	87	77	85		
798B	Protivin loam, 1 to 4 percent slopes	1.82	2.8%		lle	61	56			80	80	55	64		
84	Clyde clay loam, 0 to 3 percent slopes	1.46	2.2%		llw	88	74			90	90	75	85		
<b>Weighted Average</b>						<b>2.11</b>	<b>72.8</b>	<b>69</b>	<b>18.7</b>	<b>5.4</b>	<b>*n 80.8</b>	<b>*n 80.4</b>	<b>*n 65</b>	<b>*n 67.2</b>	<b>*n 0.1</b>

\*\*IA has updated the CSR values for each county to CSR2.

\*n: The aggregation method is "Weighted Average using all components"

\*c: Using Capabilities Class Dominant Condition Aggregation Method

Soils data provided by USDA and NRCS.