

Soils Map

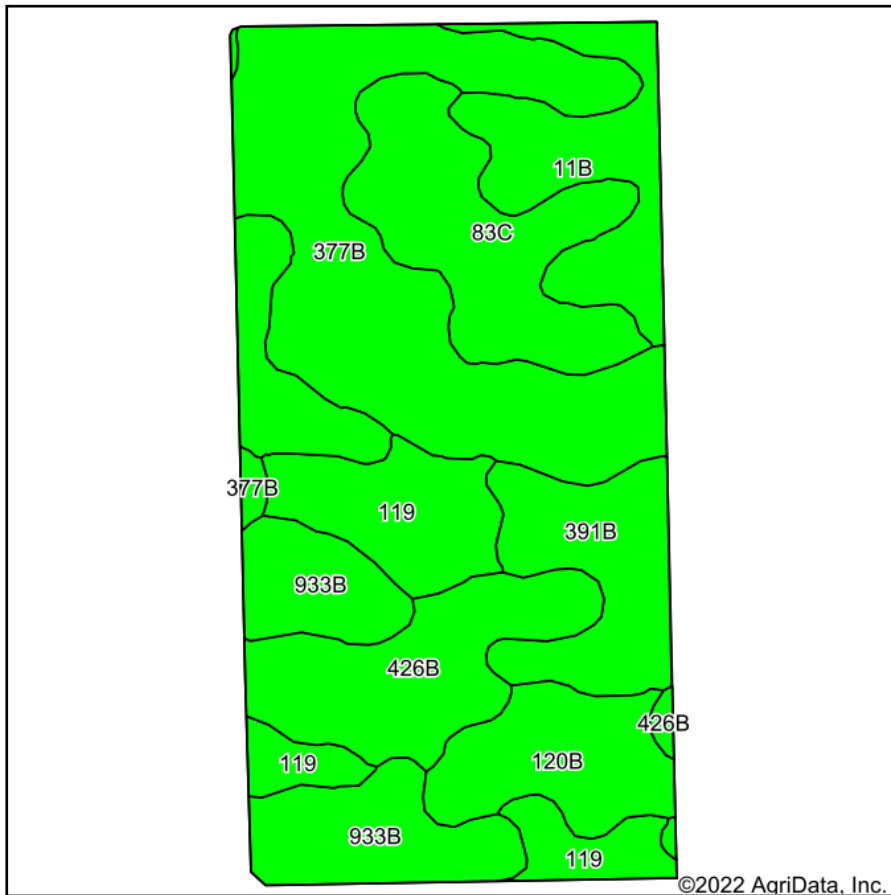

Soils data provided by USDA and NRCS.

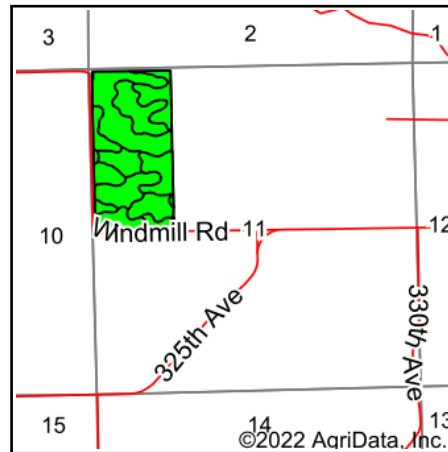

State: **Iowa**
 County: **Delaware**
 Location: **10-87N-3W**
 Township: **South Fork**
 Acres: **77.2**
 Date: **8/26/2022**



Maps Provided By:



© AgriData, Inc. 2021

www.AgriDataInc.com



Area Symbol: IA055, Soil Area Version: 28

Code	Soil Description	Acres	Percent of field	CSR2 Legend	Non-Irr Class *c	CSR2**	CSR	Corn Bu	Soybeans Bu	*n NCCPI Overall	*n NCCPI Corn	*n NCCPI Small Grains	*n NCCPI Soybeans
377B	Dinsdale silt loam, 2 to 5 percent slopes	20.01	25.9%		Ile	95	90			87	87	70	75
933B	Sawmill silty clay loam, shallow loess, 1 to 4 percent slopes, occasionally flooded	11.90	15.4%		llw	76	80			89	89	63	73
83C	Kenyon loam, 5 to 9 percent slopes	9.48	12.3%		llle	85	76	188	48.5	86	86	66	70
119	Muscatine silt loam, 1 to 3 percent slopes	8.40	10.9%		lw	95	100			94	94	80	87
426B	Aredale silt loam, 2 to 5 percent slopes	8.22	10.6%		Ile	91	86			84	84	72	63
11B	Colo-Ely complex, 0 to 5 percent slopes	6.82	8.8%		llw	86	68			92	92	65	76
391B	Clyde-Floyd complex, 1 to 4 percent slopes	6.69	8.7%		llw	87	74			88	86	70	85
120B	Tama silt loam, driftless, 2 to 6 percent slopes	5.68	7.4%		Ile	95	95			94	94	79	85
Weighted Average					2.01	88.9	84.4	23.1	6	*n 88.7	*n 88.5	*n 70	*n 75.8

**IA has updated the CSR values for each county to CSR2.

*n: The aggregation method is "Weighted Average using all components"

*c: Using Capabilities Class Dominant Condition Aggregation Method

Soils data provided by USDA and NRCS.