

Soils Map

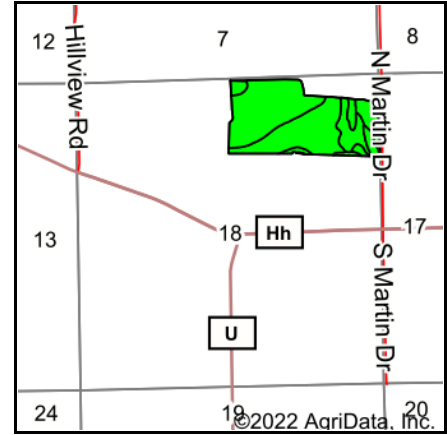

State: **Wisconsin**
 County: **Eau Claire**
 Location: **18-25N-8W**
 Township: **Clear Creek**
 Acres: **65.21**
 Date: **3/13/2022**

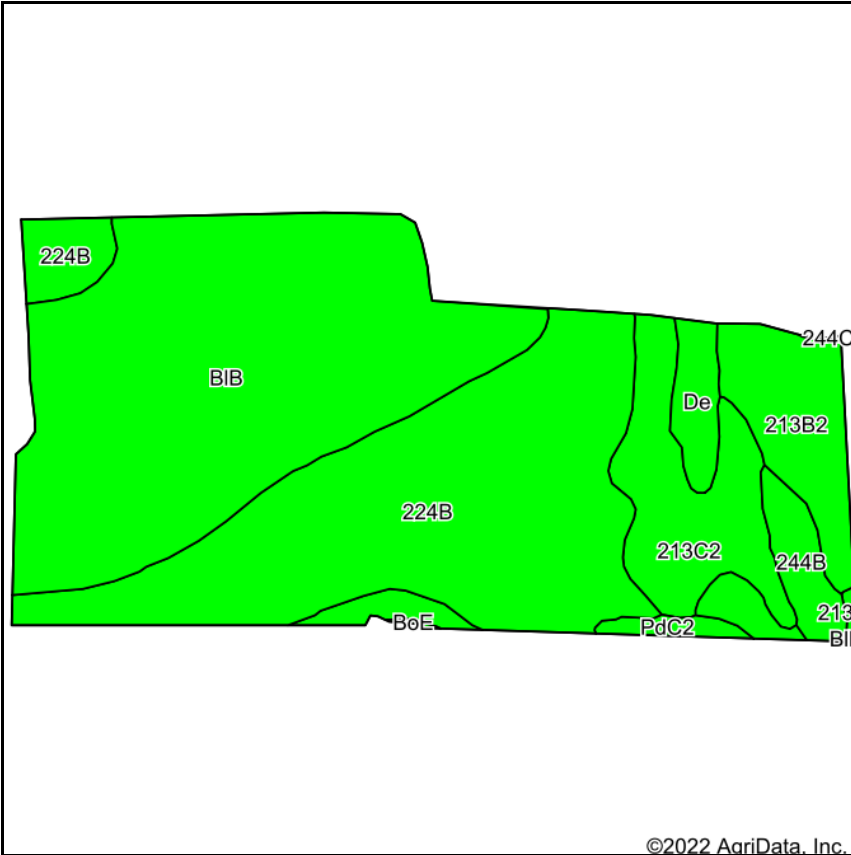

HIGH POINT
 LAND COMPANY

Maps Provided By:



surety
 CUSTOMIZED ONLINE MAPPING

© AgriData, Inc. 2021

www.AgriDataInc.com



©2022 AgriData, Inc.

Soils data provided by USDA and NRCS.

Area Symbol: WI035, Soil Area Version: 20

Code	Soil Description	Acres	Percent of field	Non-Irr Class Legend	Non-Irr Class *c	Irr Class *c	Corn Bu	Soybeans Bu
BIB	Billett sandy loam, 1 to 6 percent slopes	26.60	40.8%		IIIls		90	30
224B	Elevasil sandy loam, 2 to 6 percent slopes	23.59	36.2%		IIIls			
213C2	Hixton silt loam, 6 to 12 percent slopes, moderately eroded	6.16	9.4%		IIIe			
213B2	Hixton silt loam, 2 to 6 percent slopes, moderately eroded	4.35	6.7%		IIe			
244B	Elk mound loam, 2 to 6 percent slopes	1.64	2.5%		IIIls			
De	Dells silt loam	1.49	2.3%		IIw		105	35
224C2	Elevasil sandy loam, 6 to 12 percent slopes, moderately eroded	0.82	1.3%		IIIe			
PdC2	Plainbo loamy sand, 6 to 12 percent slopes, eroded	0.56	0.9%		VIls	IVe	35	11
Weighted Average					2.94	0.03	39.4	13.1

*c: Using Capabilities Class Dominant Condition Aggregation Method

Soils data provided by USDA and NRCS.