

# Soils Map

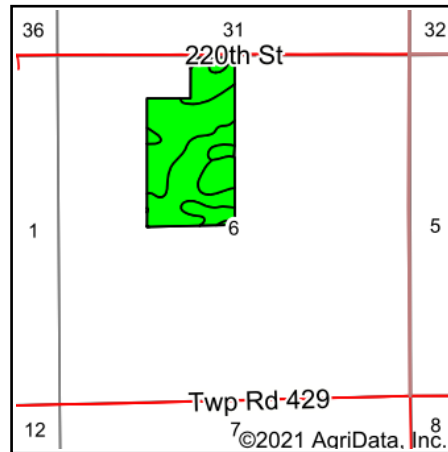

State: **Minnesota**  
 County: **Fillmore**  
 Location: **6-102N-13W**  
 Township: **Bloomfield**  
 Acres: **68.33**  
 Date: **10/20/2021**

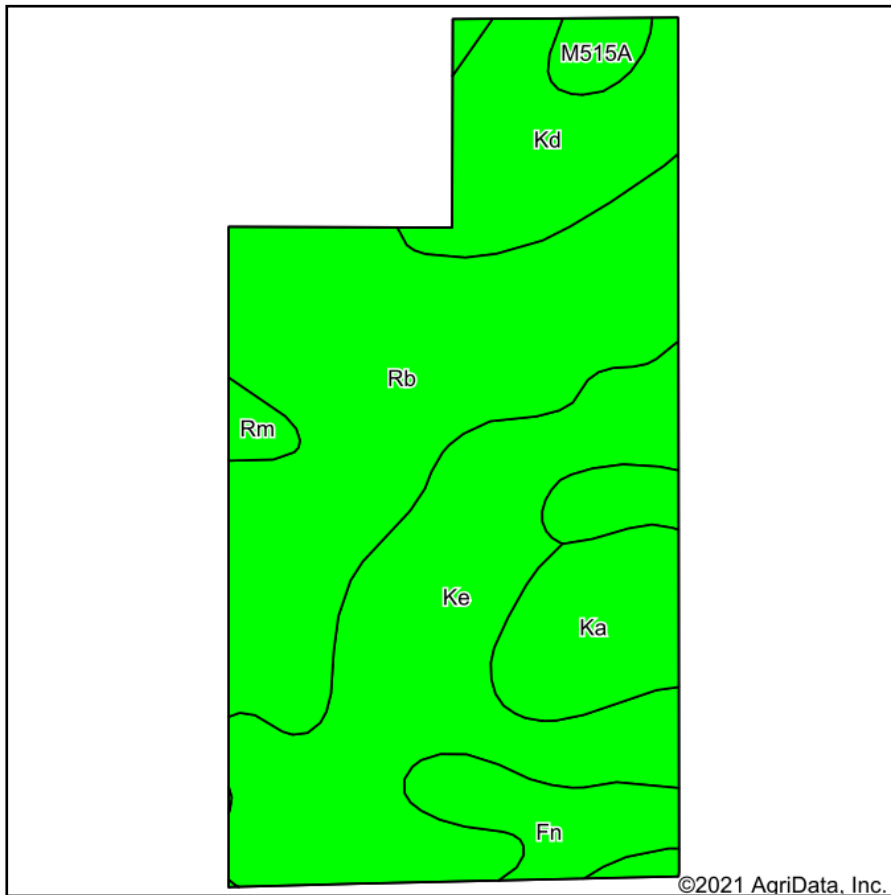

Maps Provided By:



Soils data provided by USDA and NRCS.

Area Symbol: MN045, Soil Area Version: 16

Code	Soil Description	Acres	Percent of field	PI Legend	Non-Irr Class *c	Productivity Index	Bromegrass alfalfa AUM	Bromegrass alfalfa hay Tons	Corn Bu	Kentucky bluegrass AUM	Oats Bu	Smooth bromegrass AUM	Soybeans Bu	
Rb	Racine and Ostrander silt loams, 2 to 6 percent slopes	24.63	36.0%		Ile	94		5.7	202		82		56	
Ke	Kenyon silt loam, 2 to 6 percent slopes	22.31	32.7%		Ile	97	10.8	6.2	209	3.8	89	6.3	58	
Kd	Kenyon silt loam, 0 to 1 percent slopes	7.93	11.6%		I	99		6	213		85		59	
Fn	Floyd and Clyde silty clay loams, overwash, 0 to 3 percent slopes	5.74	8.4%		Ilw	92		4.9	198		81		55	
Ka	Kasson silt loam, 0 to 1 percent slopes	5.70	8.3%		Ils	95								
M515A	Tripoli clay loam, 0 to 2 percent slopes	1.24	1.8%		Ilw	87								
Rm	Rockton and Dodgeville silt loams, shallow, 2 to 6 percent slopes	0.78	1.1%		Vle	28		4.1						
<b>Weighted Average</b>						<b>1.93</b>	<b>94.6</b>	<b>3.5</b>	<b>5.2</b>	<b>182.4</b>	<b>1.2</b>	<b>75.3</b>	<b>2.1</b>	<b>50.6</b>

\*c: Using Capabilities Class Dominant Condition Aggregation Method  
 Soils data provided by USDA and NRCS.