

# Soils Map

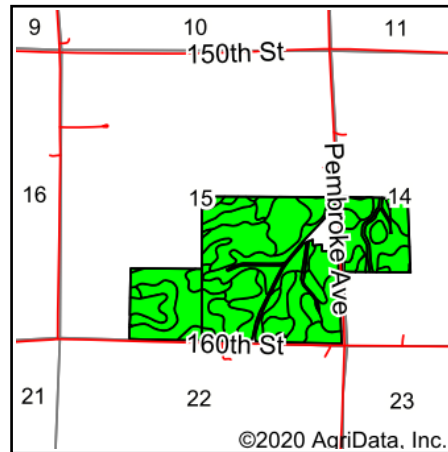

State: **Iowa**  
 County: **Chickasaw**  
 Location: **15-96N-12W**  
 Township: **Jacksonville**  
 Acres: **212.42**  
 Date: **10/15/2020**

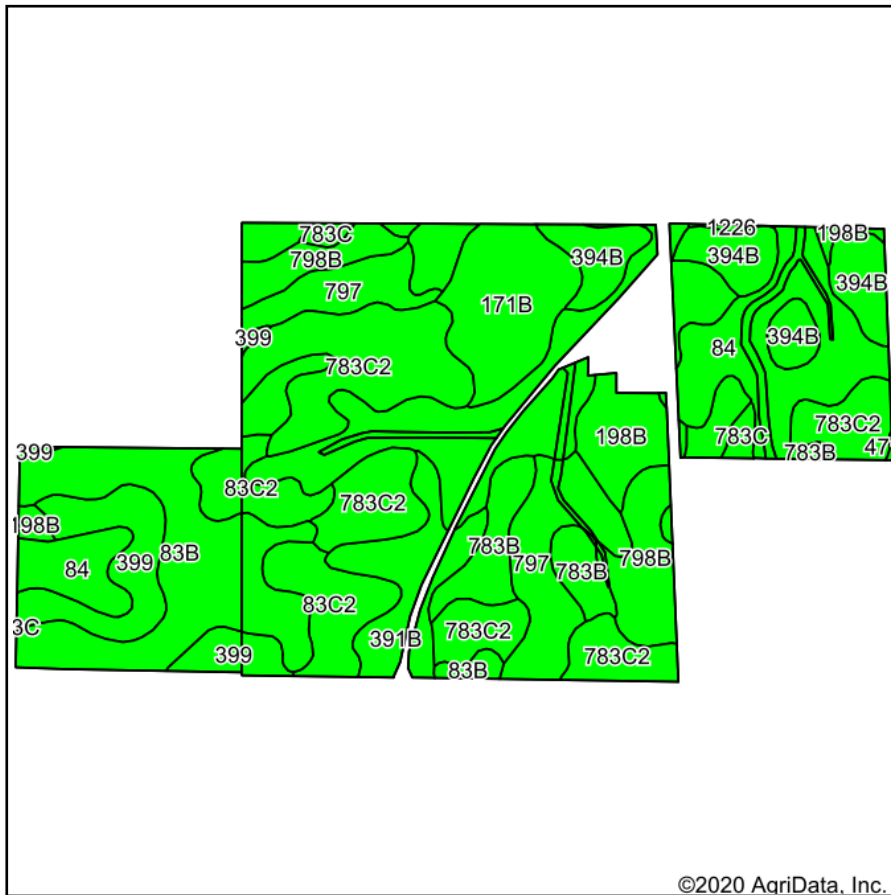

Maps Provided By:

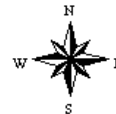

Soils data provided by USDA and NRCS.

Area Symbol: IA037. Soil Area Version: 26														
Code	Soil Description	Acres	Percent of field	CSR2 Legend	Non-Irr Class *c	CSR2**	CSR	Bromegrass alfalfa	Bromegrass alfalfa hay	Corn	Kentucky bluegrass	Oats	Smooth bromegrass	Soybeans
84	Clyde clay loam, 0 to 3 percent slopes	42.08	19.8%		llw	88	74							
783C2	Cresco loam, 5 to 9 percent slopes, moderately eroded	32.78	15.4%		llle	78	41							
83B	Kenyon loam, 2 to 5 percent slopes	28.33	13.3%		lle	90	84	11	6.6	210	3.9	91	6.6	61
797	Jameston silty clay loam, 0 to 2 percent slopes	16.23	7.6%		llw	73	56							
394B	Ostrander loam, 2 to 5 percent slopes	13.10	6.2%		lle	88	84							
798B	Protivin loam, 1 to 4 percent slopes	12.78	6.0%		lle	61	56							
171B	Bassett loam, 2 to 5 percent slopes	12.58	5.9%		lle	85	79	10.7	6.4	215	3.9	92	6.4	62
399	Readlyn silt loam, 1 to 3 percent slopes	12.34	5.8%		lw	91								
83C2	Kenyon loam, 5 to 9 percent slopes, eroded	12.21	5.7%		llle	84	67	10.6	6.3	212	3.7	88	6.2	61



198B	Floyd loam, 1 to 4 percent slopes	10.17	4.8%		llw	89	74								
391B	Clyde-Floyd complex, 1 to 4 percent slopes	9.34	4.4%		llw	87	72								
783B	Cresco loam, 2 to 5 percent slopes	8.08	3.8%		lle	73	66								
783C	Cresco loam, 5 to 9 percent slopes	2.10	1.0%		llle	81	46								
1226	Lawler loam, 0 to 2 percent slopes, rarely flooded	0.23	0.1%		lls	59	71								
471B	Oran loam, 2 to 5 percent slopes	0.07	0.0%		lw	74	79								
<b>Weighted Average</b>						<b>83</b>	<b>*-</b>	<b>2.7</b>	<b>1.6</b>	<b>52.9</b>	<b>1</b>	<b>22.6</b>	<b>1.6</b>	<b>15.3</b>	

\*\*IA has updated the CSR values for each county to CSR2.

\*- CSR weighted average cannot be calculated on the current soils data, use prior data version for csr values.

\*c: Using Capabilities Class Dominant Condition Aggregation Method

Soils data provided by USDA and NRCS.